

VGSH 4001.

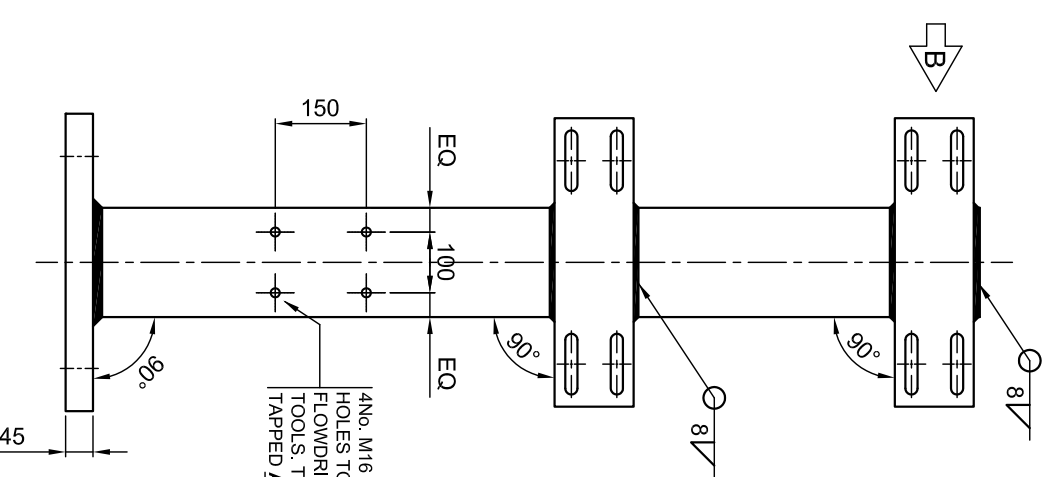

TRAFFIC FACE ELEVATION ON POST.

MINIMUM 10mm DIAMETER GALVANISING VENT HOLES EITHER SIDE OF THE POST. HOLES TO BE FITTED WITH PERMANENT PLASTIC BUNG AFTER GALVANISING.

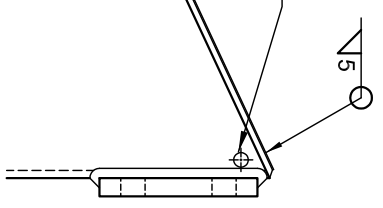

ENLARGED VIEW ON ARROW 'B'.

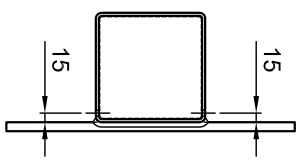

PLAN VIEW ON TOP CLEAT.

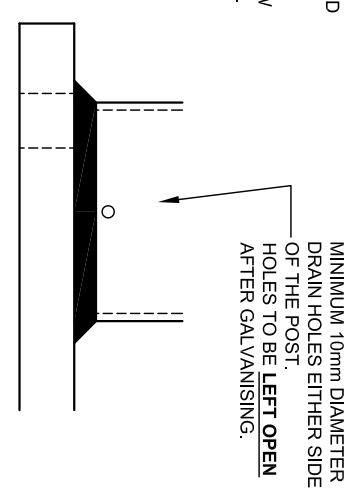

ENLARGED VIEW ON POST DRAIN HOLES.

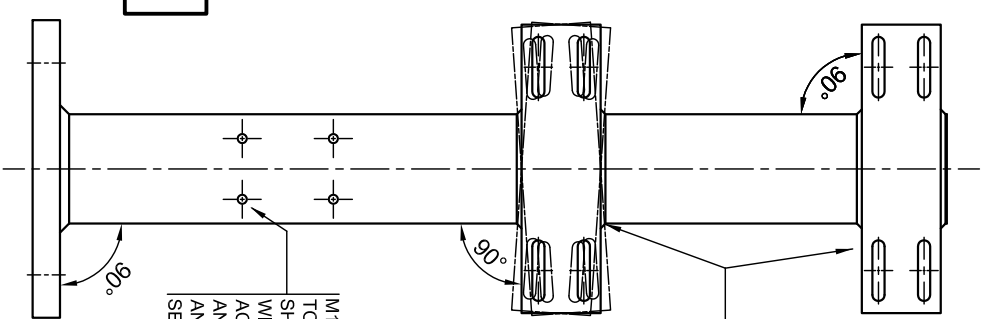

TRAFFIC FACE ELEVATION ON POST.

FOR POST RAKES UP TO AND INCLUDING 4°00'.

THE TOP TWO CLEATS ARE TO BE RAKED AT ONE DEGREE INTERVALS EITHER LEFT OR RIGHT TO SUIT SPECIFIC STRUCTURES.

M16 FLOW TAPPED HOLES ARE TO MAINTAIN THE SET OUT SHOWN UP TO FOUR DEGREES WITH THE LOWER BRACKET ACCOMMODATING THE ANGULAR VARIANCE FOR ANGLE ABOVE FOUR DEGREES SET OUT TO BE AMENDED.

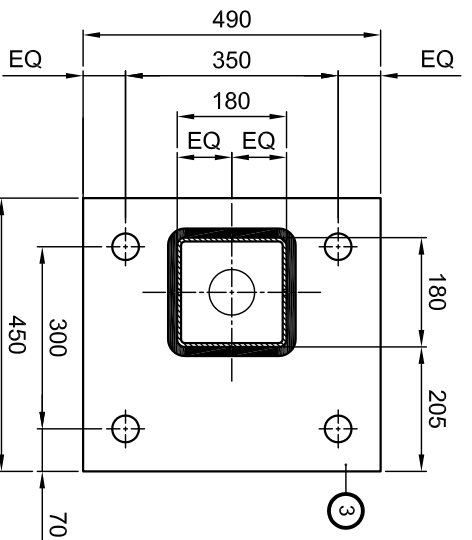

SECTION A-A.

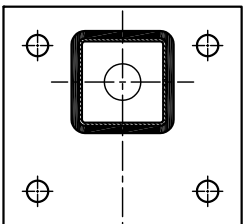

SECTION A-A (APPLICABLE TO VGSH 4002 ONLY.)

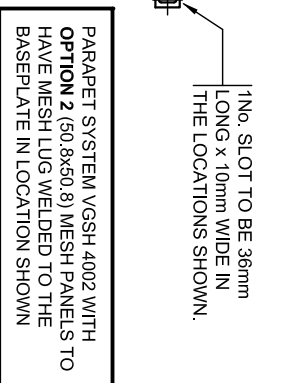

SECTION A-A (APPLICABLE TO VGSH 4002 ONLY.)

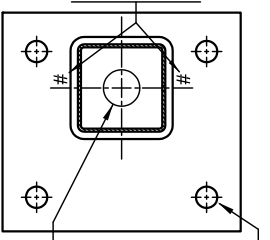

VIEW ON BASEPLATE.

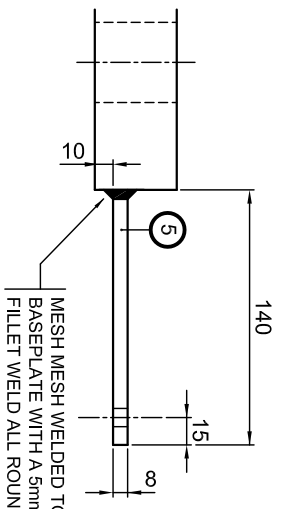

ENLARGED VIEW ON MESH LUG.

GENERAL NOTES.

1. ALL STEEL WELDING TO BE IN ACCORDANCE WITH BS.EN.1011-1 AND BS.EN.1011-2.
2. WELDERS AND WELDING PROCEDURES ARE IN ACCORDANCE WITH BS.EN.287-1 AND BS.EN.ISO.15607 RESPECTIVELY.
3. DIMENSIONS RELATIVE TO HEIGHT DATUM ASSUME THERE IS NO LONGITUDINAL FALL ON THE PLINTH, ADDITIONAL TOLERANCES TO TAKE ACCOUNT OF THESE FALLS ARE PERMISSIBLE.

MATERIAL SPECIFICATION.		
ITEM	SPECIFICATION	ITEM
POST SECTION.	ALL STEEL SECTIONS ARE TO BE IN ACCORDANCE WITH BS.EN.10025-1, BS.EN.10025-2, BS.EN.10210-1, BS.EN.10210-2.	BOLTS.
BASEPLATE.	POST SECTIONS TO BE GRADE S355J2H, POST CLEATS TO BE GRADE S275J0 AND BASEPLATE TO BE GRADE S355J2.	NUTS.
POST CLEAT.		WASHERS.
MESH LUG.		

SECTION SCHEDULE	
1	POST SECTION 180x180x6.3 SHS
2	BASEPLATE SECTION 490x490x4.5
3	RAIL CLEAT 47x318x15 PLATE
4	MESH LUG SECTION 50x8

Varley and Gulliver Ltd.
 Alfred Street, Sparkbrook, Birmingham B12 8JR
 Tel: 44 (0) 121 773 2441
 Fax: 44 (0) 121 766 6875
 Website: www.v-and-g.co.uk

Alfred Street, Sparkbrook, Birmingham B12 8JR
 Tel: 44 (0) 121 773 2441
 Fax: 44 (0) 121 766 6875
 Website: www.v-and-g.co.uk

Alfred Street, Sparkbrook, Birmingham B12 8JR
 Tel: 44 (0) 121 773 2441
 Fax: 44 (0) 121 766 6875
 Website: www.v-and-g.co.uk