

TYPICAL ELEVATION ON THE VARLEYGUARD PARAPET.

PLUS ANY LONGITUDINAL OR TRANSVERSE CROSSFALLS OF THE CONCRETE PLINTH.

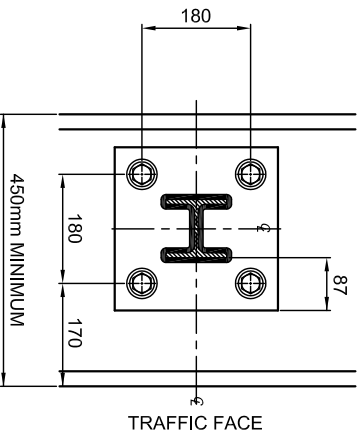
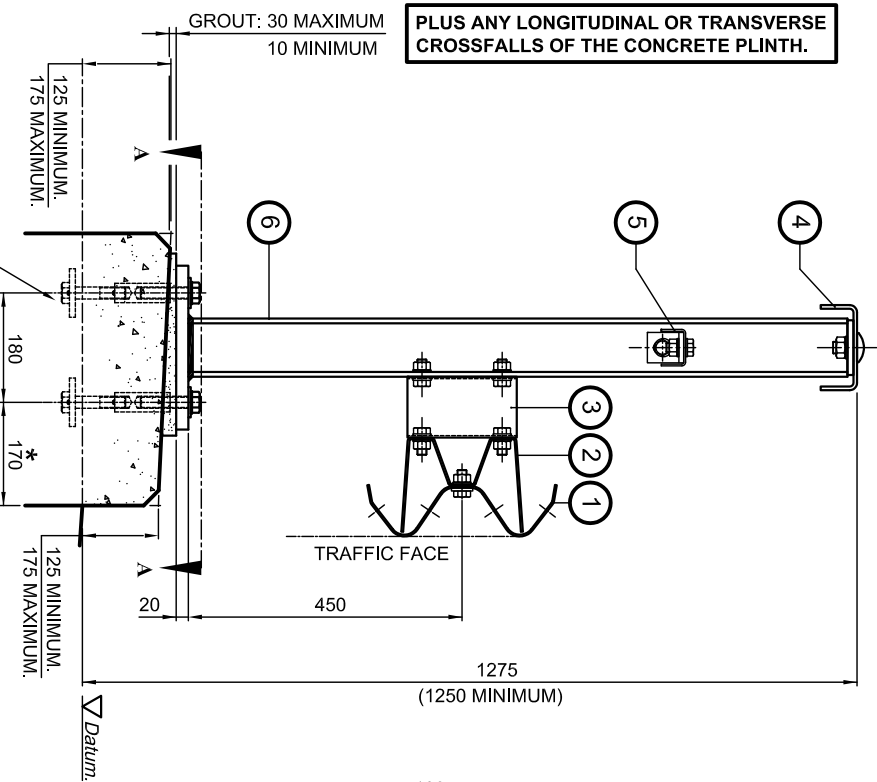

Varley/GUARD SERIES PARAPET IS A MODULAR SYSTEM BASED ON 2000mm POST CENTRES. THE SYSTEM IS A LOW TOLERANCE SYSTEM AND REQUIRES THE ANCHORAGES TO BE CAST TO A TOLERANCE OF +/-2mm AND MUST NOT BE ACCUMULATIVE. SPECIAL POST CENTRES AT EXPANSION JOINTS AND END OF PARAPET RUNS ADJACENT TO END POSTS CAN BE UTILISED BUT WILL RESULT IN SPECIAL COMPONENTS BEING REQUIRED.

GENERAL NOTES.

1. ALL STEEL WELDING TO BE IN ACCORDANCE WITH BS.EN.1011-1 AND BS.EN.1011-2.
2. WELDERS AND WELDING PROCEDURES ARE IN ACCORDANCE WITH BS.EN.287-1 AND BS.ENISO.15607 RESPECTIVELY.
3. MAIN RAILS CAN BE RADIUS TO SUIT ON SITE DOWN TO MINIMUM RADIUS OF 500mm. TIGHTER RADIUS CAN BE SUPPLIED PREFORMED BY SPECIAL ARRANGEMENT.
4. DIMENSIONS RELATIVE TO HEIGHT DATUM ASSUME THERE IS NO LONGITUDINAL FALL ON THE PLINTH. ADDITIONAL TOLERANCES TO TAKE ACCOUNT OF THESE FALLS ARE PERMISSIBLE.
5. AN EASILY LEGIBLE IDENTIFICATION PLATE SHALL BE APPLIED AND LOCATED NEAR TO THE TOP OF THE FIRST POST AT EACH APPROACH END IN AN EASILY VISIBLE POSITION.

ITEM	SPECIFICATION	ITEM	SPECIFICATION
TOP HANDRAILS.	ALL STEEL SECTIONS ARE TO BE IN ACCORDANCE WITH BS.EN.10025-1, BS.EN.10025-2, BS.EN.10210-1, BS.EN.10210-2, BS.EN.10219-1 & BS.EN.10219-2.	HOLDING DOWN SETSCREWS TO CONFORM TO BS.3692 AND BE STAINLESS STEEL TO BS.EN.ISO.2006-1 GRADE A4/80. M20 BOLTS / SCREWS TO BE GALVANISED STEEL TO CONFORM TO BS.5692, BS.EN.ISO.4014 AND 4017 GRADE 8.8.	
INTER RAILS.	POST SECTIONS & JOINTS TO BE GRADE S235JO. BEAMS TO BE GRADE S275JR. TOP RAIL TO BE GRADE S235J2H & BASEPLATE SPACER BRACKET TO BE GRADE S355J2G3.	ALL NUTS TO BE GALVANISED STEEL TO CONFORM TO BS.3692 AND BS.ENISO.4032 GRADE 8. M20 AND M16 NYLOC NUTS TO DIN985 TO BE GRADE 8.	
POST SECTION.	BASEPLATE.	WASHERS.	GALVANISED PLAIN WASHERS TO BE M20x50 o.d. x 4mm THICK AND M16 FROM 'F' CONFORMING TO BS.4320. M16 NYLON WASHERS TO BE NYLON 66.
SPACER.			
BACKING BEAM.			
FRONT BEAM.			

VARLEYGUARD SERIES POST INFORMATION.

UNFACTORED MOMENT OF RESISTANCE OF POST (kNm) AT UNDERSIDE OF BASEPLATE.	29.5
UNFACTORED SHEAR FORCE RESISTANCE OF POST (kN)	98.4
SIZE OF HOLDING DOWN BOLTS	M20

LIST OF ADDITIONAL REFERENCE DRAWING FOR VARLEYGUARD PARAPETS.

DRAWING NUMBER	TITLE
V2G / 02.	STANDARD JOINT DETAILS.
V2G / 03.	EXPANSION JOINT DETAILS.
V2G / 04.	CONNECTION DETAILS.
V2G / 05.	PARAPET POST DETAILS.
V2G / 06.	TRANSITION TO TRANZIFLEX 155 DETAILS.

APPROVED ANCHORAGE UNITS

DRAWING NUMBER	APPROVED ANCHORAGE UNITS
VGAS/1.	
VGAS/2.	
VGAS/3.	
OR OTHER APPROPRIATELY APPROVED CAST-IN OR DRILLED ANCHORAGE SYSTEM.	

VARLEYGUARD SERIES PARAPET PERFORMANCE.

BS.EN.1317-1 and BS.EN.1317-2.	VARLEYGUARD SERIES PARAPET PERFORMANCE.
IMPACT TEST CRITERIA.	TB14 and TB91.
CONTAINMENT LEVEL.	H2.
WORKING WIDTH.	W1. (0.6m)
IMPACT SEVERITY LEVEL.	B.
DYNAMIC DEFLECTION.	0.4m.

SEE ANCHORAGE TABLE BELOW.

M20x50 O/D. x 4mm THICK GALVANISED STEEL WASHER BETWEEN NYLON WASHER AND BASEPLATE.

M20 NYLON TOP HAT WASHER BETWEEN UNDERSIDE OF BOLT HEAD AND GALVANISED WASHER.

ENLARGED VIEW ON HOLDING DOWN BOLT. (IMPORTANT)

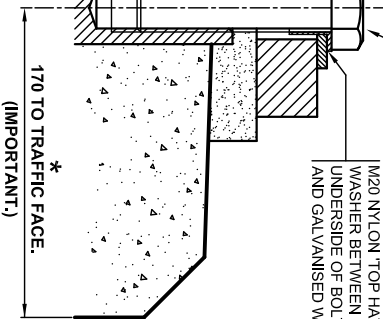

SECTION SCHEDULE	Rev	Date	By	Description
1				MANUFACTURING TOLERANCES AS SHOWN UNLESS STATED OTHERWISE. DIMENSIONS: TOLERANCES: GREATER THAN 1000mm: ± 2mm LESS THAN 1000mm: ± 1mm ANGULAR DIMENSIONS: ± 0°15'
2				NOTE: ALL ACCUMULATIVE TOLERANCES ARE TO BE CONTAINED WITHIN THE OVERALL TOLERANCE.
3				SITE ERECTION TOLERANCES.
4				WILL VARY TO SUIT SITE CONDITIONS.
5				ALL STANDARDS QUOTED ARE DEEMED CURRENT AT THE DATE THE DRAWING IS ISSUED FOR APPROVAL, UNLESS OTHERWISE STATED.
6				THIS DRAWING TO BE USED ONLY WITH W/O No. _____

SCALE: P.G.H. DATE: 27/01/2011

DRAWING TO BE RETURNED TO DRAWING OFFICE ON COMPLETION OF WORK.

Alfred Street, Sparkbrook, Birmingham B12 8JR  
Tel: 44 (0) 121 773 2441  
Fax: 44 (0) 121 766 6875  
Website: www.v-and-g.co.uk

STANDARD ARRANGEMENT DRAWINGS OF VARLEYGUARD SERIES STEEL PARAPET SYSTEM.

DRAWING NUMBER: V2G - 01.